

FOR LEASE

COMMERCE PARK CLACKAMAS

16081 SE 98TH AVE, BLDG C
CLACKAMAS, OR



±4,950 SF Shell – Suite 16081

±4,950 SF shell	Can be combined with adjacent space to total 9,900 SF shell
±769 SF office	±16' clear height
Available with or without ±1,350 SF of cooler for sale by current tenant	Fully-sprinklered
2 dock-high doors	Easy access to Hwy 212 & I-205
1 grade-level door	End cap unit
	Ample parking

±4,950
SHELL SF

±16'
CLEAR HEIGHT

CALL
FOR LEASE RATES

KIDDER.COM COMMERCE-PARKS.COM

This information supplied herein is from sources we deem reliable. It is provided without any representation, warranty, or guarantee, expressed or implied as to its accuracy. Prospective Buyer or Tenant should conduct an independent investigation and verification of all matters deemed to be material, including, but not limited to, statements of income and expenses. Consult your attorney, accountant, or other professional advisor.

STEVEN KLEIN
503.221.2260
steven.klein@kidder.com

PETER STALICK
503.221.2272
peter.stalick@kidder.com

BRENDAN MURPHY
503.721.2705
brendan.murphy@kidder.com

GENEVIEVE KLEIN
503.915.9192
genevieve.klein@kidder.com

MANAGED BY

Lincoln

EXCLUSIVELY LEASED BY

km Kidder Mathews

COMMERCE PARK CLACKAMAS - BLDG C



$\pm 4,950$

SHELL SF

2

DOCK-HIGH DOORS

1

GRADE-LEVEL DOOR

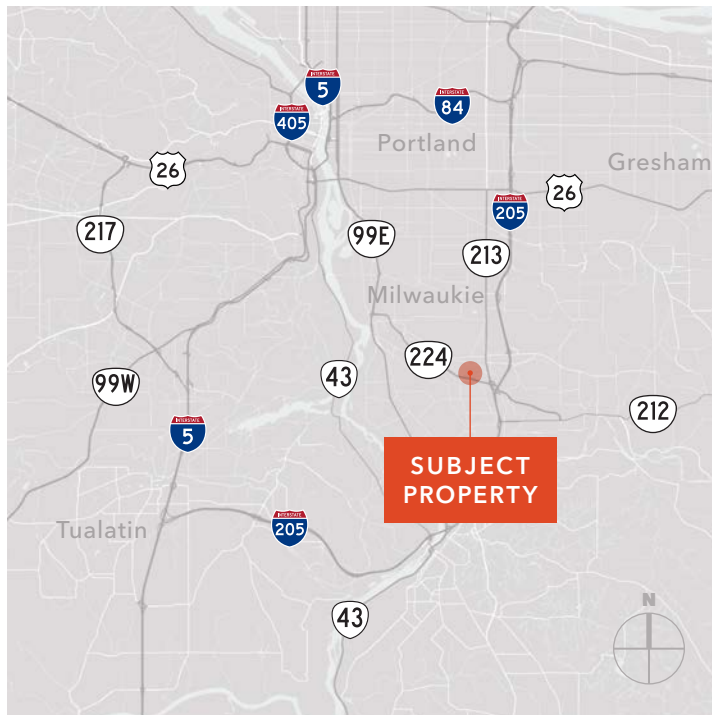

For more leasing information, contact

STEVEN KLEIN
503.221.2260
steven.klein@kidder.com

PETER STALICK
503.221.2272
peter.stalick@kidder.com

BRENDAN MURPHY
503.721.2705
brendan.murphy@kidder.com

GENEVIEVE KLEIN
503.915.9192
genevieve.klein@kidder.com

KIDDER.COM

This information supplied herein is from sources we deem reliable. It is provided without any representation, warranty, or guarantee, expressed or implied as to its accuracy. Prospective Buyer or Tenant should conduct an independent investigation and verification of all matters deemed to be material, including, but not limited to, statements of income and expenses. Consult your attorney, accountant, or other professional advisor.

MANAGED BY

Lincoln

EXCLUSIVELY LEASED BY

km Kidder Mathews