

FOR LEASE

# COMMERCE PARK MILWAUKIE

13551-13539 SE JOHNSON RD, BLDG 5, MILWAUKIE, OR



*132,000 SF Available; Divisible to 44,000 SF*

±1,721 SF office

25 dock-high doors

3 grade-level doors

Many docks equipped with  
pit levelers or edge of dock  
levelers and door seals

±22' clear height

Fully sprinklered

Freezer space: ±11,245 SF

Cooler space: ±4,554 SF

Space is divisible to exclude  
cooler/ freezer for standard  
industrial users

Excellent proximity to I-205  
freeway and access to  
downtown Portland

Many amenities are nearby,  
including banks, post offices,  
several stores and restaurants

Call for lease rate

STEVEN KLEIN  
503.221.2260  
steven.klein@kidder.com

PETER STALICK  
503.221.2272  
peter.stalick@kidder.com

BRENDAN MURPHY  
503.721.2705  
brendan.murphy@kidder.com

OWNED BY

LINCOLN  
PROPERTY  
COMPANY

EXCLUSIVELY LEASED BY

**km** Kidder  
Mathews

KIDDER.COM    COMMERCE-PARKS.COM

This information supplied herein is from sources we deem reliable. It is provided without any representation, warranty, or guarantee, expressed or implied as to its accuracy. Prospective Buyer or Tenant should conduct an independent investigation and verification of all matters deemed to be material, including, but not limited to, statements of income and expenses. Consult your attorney, accountant, or other professional advisor.

## COMMERCE PARK MILWAUKIE - BLDG 5

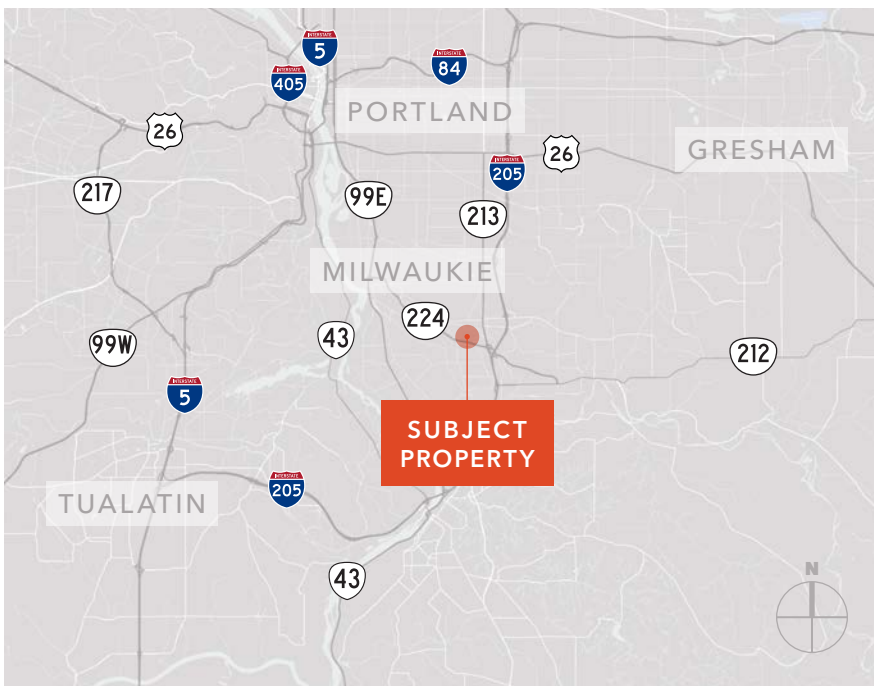
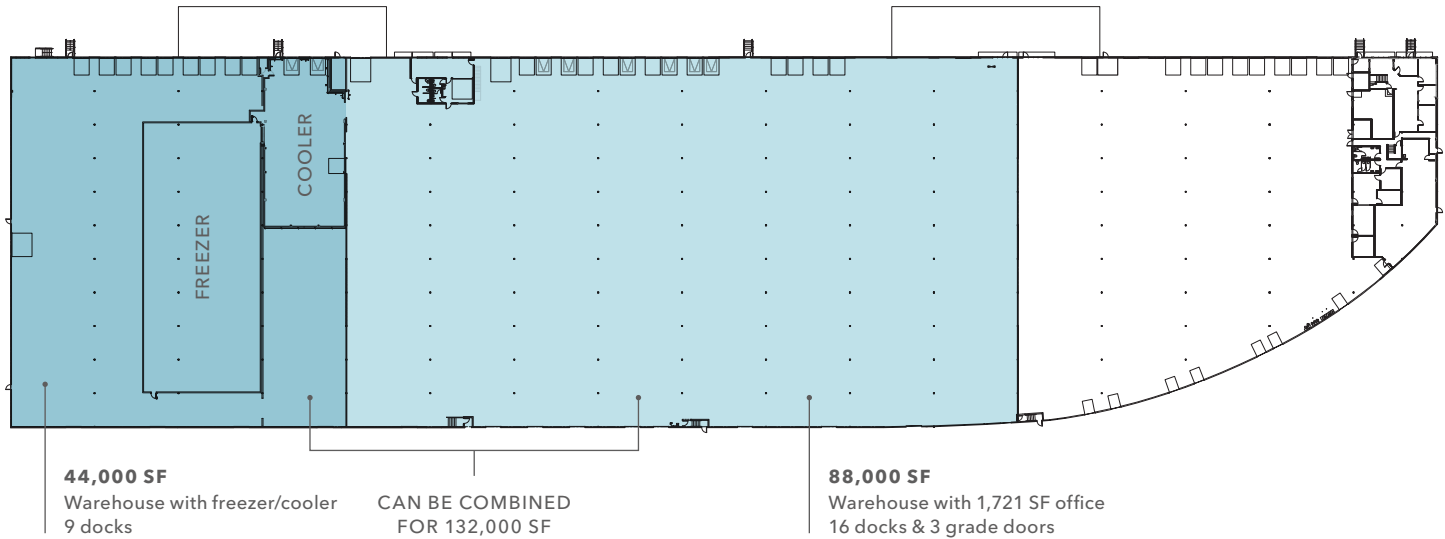

*For more leasing information, contact*

**STEVEN KLEIN**  
503.221.2260  
steven.klein@kidder.com

**PETER STALICK**  
503.221.2272  
peter.stalick@kidder.com

**BRENDAN MURPHY**  
503.721.2705  
brendan.murphy@kidder.com

**KIDDER.COM**   **COMMERCE-PARKS.COM**

This information supplied herein is from sources we deem reliable. It is provided without any representation, warranty, or guarantee, expressed or implied as to its accuracy. Prospective Buyer or Tenant should conduct an independent investigation and verification of all matters deemed to be material, including, but not limited to, statements of income and expenses. Consult your attorney, accountant, or other professional advisor.

OWNED BY  
**LINCOLN  
PROPERTY  
COMPANY**

EXCLUSIVELY LEASED BY

**km** **Kidder  
Mathews**