

FOR LEASE

COMMERCE PARK WILSONVILLE

10965 SW COMMERCE CIRCLE, BLDG A, SUITE F
WILSONVILLE, OR



Frontage on I-5 at the Stafford Interchange offers prime freeway exposure, quick access, and nearby amenities.

6,571 SF shell	Fully sprinklered
1,985 SF office	End cap unit
2 dock-high doors	Call for quote
1 grade-level door	Available now
17' clear height	

6,571

SHELL SF

1,985

OFFICE SF

17'

CLEAR HEIGHT

KIDDER.COM

COMMERCE-PARKS.COM

This information supplied herein is from sources we deem reliable. It is provided without any representation, warranty, or guarantee, expressed or implied as to its accuracy. Prospective Buyer or Tenant should conduct an independent investigation and verification of all matters deemed to be material, including, but not limited to, statements of income and expenses. Consult your attorney, accountant, or other professional advisor.

STEVEN KLEIN
503.221.2260
steven.klein@kidder.com

PETER STALICK
503.221.2272
peter.stalick@kidder.com

BRENDAN MURPHY
503.721.2705
brendan.murphy@kidder.com

GENEVIEVE KLEIN
503.915.9192
genevieve.klein@kidder.com

MANAGED BY

Lincoln

EXCLUSIVELY LEASED BY

km Kidder Mathews

COMMERCE PARK WILSONVILLE - BLDG A, SUITE F

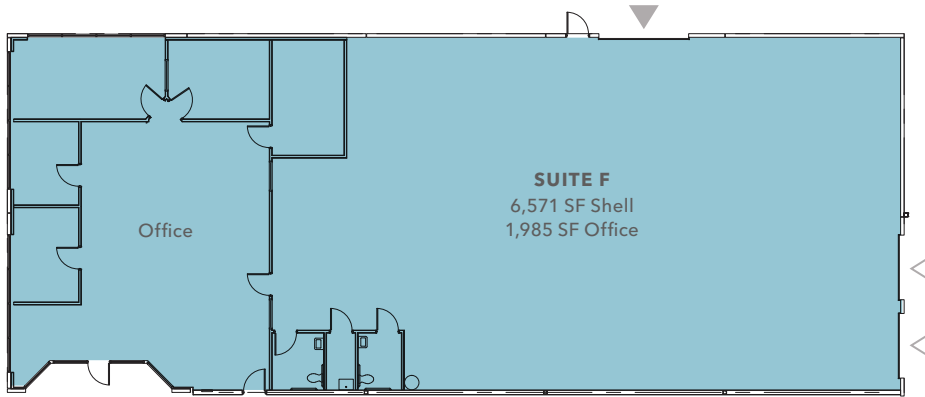

6,571

SHELL SF

2

DOCK-HIGH DOORS

1

GRADE-LEVEL DOOR

- ▲ Grade-level loading
- △ Dock-high loading

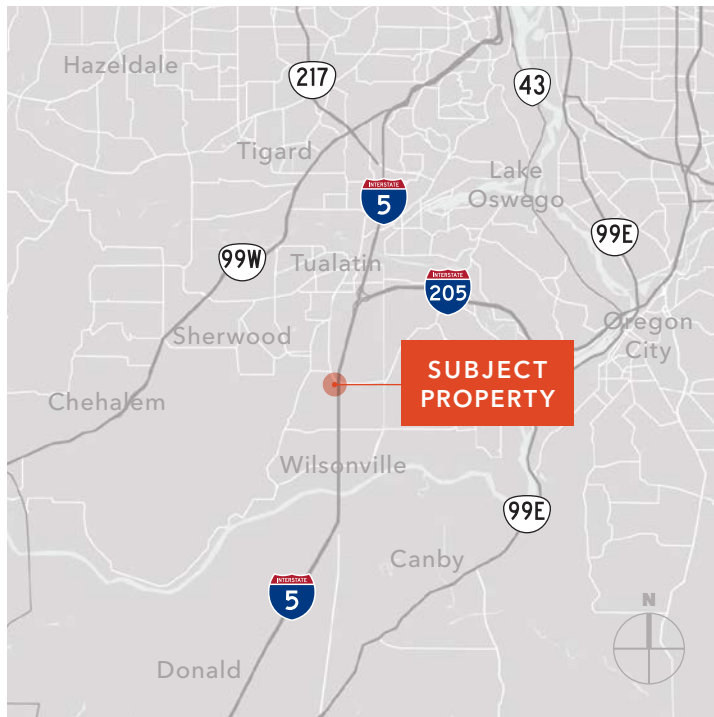

For more leasing information, contact

STEVEN KLEIN
503.221.2260
steven.klein@kidder.com

PETER STALICK
503.221.2272
peter.stalick@kidder.com

BRENDAN MURPHY
503.721.2705
brendan.murphy@kidder.com

GENEVIEVE KLEIN
503.915.9192
genevieve.klein@kidder.com

KIDDER.COM

This information supplied herein is from sources we deem reliable. It is provided without any representation, warranty, or guarantee, expressed or implied as to its accuracy. Prospective Buyer or Tenant should conduct an independent investigation and verification of all matters deemed to be material, including, but not limited to, statements of income and expenses. Consult your attorney, accountant, or other professional advisor.

MANAGED BY

Lincoln

EXCLUSIVELY LEASED BY

km Kidder Mathews